

Jayco | Redhawk SE Class C Motorhome

REDHAWK SE

COMFORT FOR THE ROAD AHEAD



2+3
YEAR | YEAR
WARRANTY

INTERIOR DESIGN



ASHVILLE



Wood



Floor



Countertop



Main Fabric



Furniture

22A, 22AF

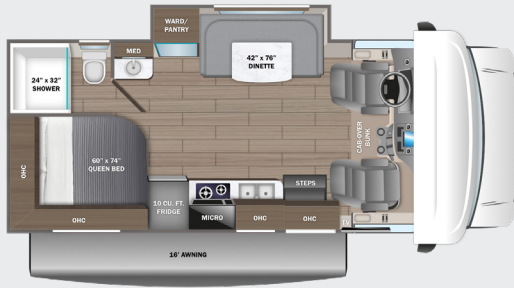

22C, 22CF

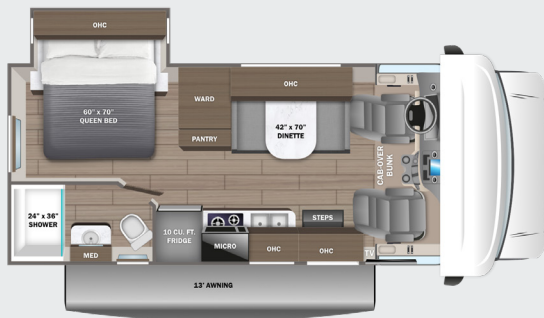

27N, 27NF

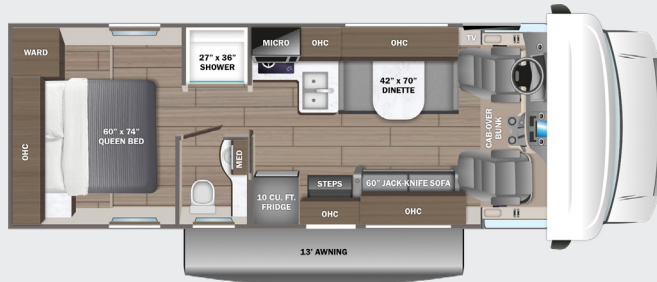

EXTERIOR



Standard Graphics Package

STANDARDS & OPTIONS

CUSTOMER VALUE PACKAGE

- One-piece, seamless, fiberglass front cap
- Heated holding tanks (12V pads)
- Electric patio awning
- Black holding tank sprayer
- Backup camera
- LED HD Smart TV

DRIVING

Chassis Equipment for 22A, 22C, 27N

- Chevy® 4500 chassis
- GVWR- 14,200 lb.
- GCWR- 20,000 lb.
- 6.6L Vortec V8 401 HP engine with 464 ft.-lb. torque
- Hydra-matic 6-speed automatic transmission with overdrive
- 150-amp alternator
- 5,000 lb. hitch with 500 lb. tongue capacity and 7-pin plug
- 57 gal. fuel tank
- StabiliTrak stability control system
- OnStar with 4G LTE

Chassis Equipment for 22AF, 22CF, 27NF

- Ford® E-450 chassis
- GVWR- 14,500 lb.
- GCWR- 22,000 lb.
- 7.3L V-8 325 HP engine with 450 ft.-lb. torque
- 6-speed TorqShift® series transmission with overdrive
- 210-amp alternator
- 7,500 lb. hitch with 750 lb. tongue capacity and 7-pin plug
- 55 gal. fuel tank
- Tire pressure monitoring system (TPMS)
- Catalytic converter theft deterrent
- Electronic stability control
- Traction control

Driving Equipment on All Floorplans

- E-rated highway tires- LT225/75R16

- 12V chassis battery
- Power anti-lock brakes with power steering
- Remote-controlled, side-view mirrors
- Hill start assist
- Tilt steering wheel
- Cruise control
- Power windows and door locks
- Auxiliary start switch
- Driver and passenger airbags
- Privacy curtains for cab area

EXTERIOR

- StrongholdVBL™ roof, floor and sidewalls
- Bead-foam insulation (R-24 max roof, R-9 max floor, R-5 max walls)
- TPO laminated roof
- Aluminum running boards
- Fiberglass exterior walls with vinyl graphics
- Leveling jack prep
- Entrance door with industry's largest travel-view window
- Electric-powered entrance step with integrated house battery compartment
- Third brake light
- Roof ladder
- 4 in. bumper tube sewer hose storage
- Cable TV hookup with RG-6 coax
- Digital antenna with signal booster
- 4,000W generator
- Solar prep
- 12V house battery
- Transfer switch with reverse polarity protection
- 30-amp electrical service
- 12.2 gal. propane tank (41 lb.)
- LP quick-connect hookup
- Exterior utility center
- Winterization drain system
- Outside shower
- 12V demand water pump
- Water filtration system

INTERIOR

- Overhead bunk with 750 lb. capacity
- 84 in. ceiling height
- High-intensity, recessed LED ceiling lights
- Hardwood cabinet doors
- Ball-bearing drawer guides
- Interior entrance door grab handle
- Interior command center
- Pleated blackout shades
- 13,500 BTU ducted A/C
- 30,000 BTU auto-ignition furnace
- 6 gal. gas/electric DSI auto-ignition water heater
- Jayco-exclusive, easy-operation legless dinette table
- 2-point lap safety belts in all designated seating locations
- Car seat tethers (select floorplans)
- 10 cu. ft. 12V refrigerator
- 2-burner cooktop with flush cover
- Convection microwave oven
- Stainless steel kitchen sink
- Decorative kitchen backsplash
- Shower with decorative ABS surround and skylight
- Stainless steel bathroom sink
- Toilet with foot flush
- Queen-size bed with bedspread
- Under-bed storage (select models)
- Large wardrobes
- Smoke alarm
- Carbon monoxide detector
- Fire extinguisher

OPTIONS

- Automatic hydraulic leveling jacks
- 200W solar panel with dual controller and second house battery

FLOORPLAN	GVWR (lbs.)	GCWR (lbs.)	WHEEL BASE	OVERALL LENGTH	EXTERIOR HEIGHT WITH SATELLITE AND A/C	EXTERIOR WIDTH	INTERIOR HEIGHT	FRESH WATER CAPACITY (gal.)	GRAY WASTE WATER CAPACITY (gal.)	BLACK WASTE WATER CAPACITY (gal.)	
CHEVY	22A	14,200	20,000	159"	25' 2"	11' 6"	100"	84"	44	40	32
	22C	14,200	20,000	159"	25' 2"	11' 6"	100"	84"	44	40	31
	27N	14,200	20,000	191"	30' 3"	11' 6"	100"	84"	39	41	31
FORD	22AF	14,500	22,000	159"	24' 8"	11' 6"	100"	84"	44	40	32
	22CF	14,500	22,000	159"	24' 8"	11' 6"	100"	84"	44	40	31
	22NF	14,500	22,000	191"	29' 7"	11' 6"	100"	84"	39	41	31

Meet your Jayco Dealer



Scan QR code for specification definitions

Some specs at the time of print may include estimates. For the most updated information, please visit Jayco.com

Jayco Inc. | P.O. Box 460 | Middlebury, IN 46540

See dealer for further information and prices. All information in this brochure and on www.jayco.com is the latest available at the time of publication approval. Jayco reserves the right to make changes and to discontinue models without notice or obligation. Photography may show optional equipment or props used for decoration purposes only. RVs built for sale in Canada may differ to conform to Canadian codes. JAYCO and the JAYCO BIRD IN FLIGHT are registered trademarks of Jayco, Inc. Printed in USA 10/23 ©2023 Jayco, Inc.



Jayco - Part of Jayco Family of Companies