

2003 Qwest® Travel Trailers and Fifth Wheels by Jayco

Floorplans & Specifications



# 2003 Qwest® Travel Trailer Floorplans

190 L

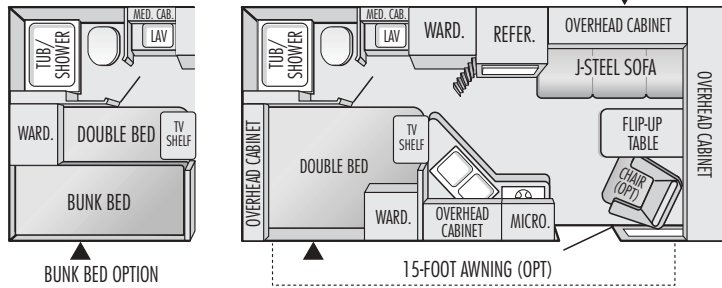

244 B

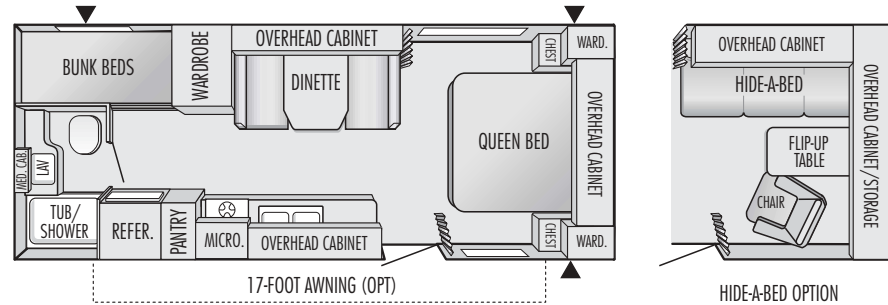

246 K

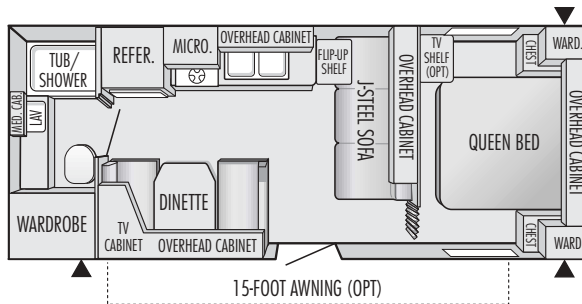

256 D

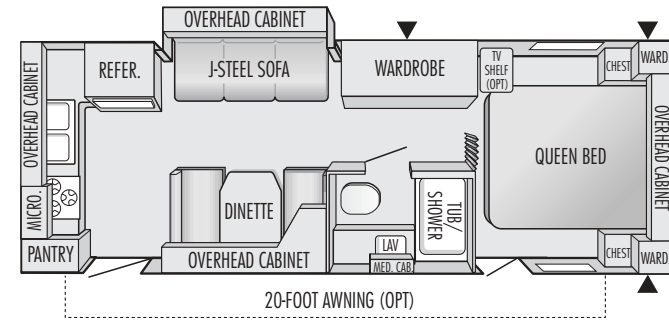

New Model

294 J

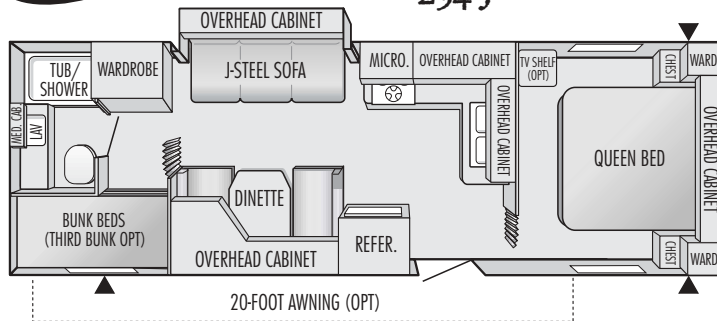

324 G

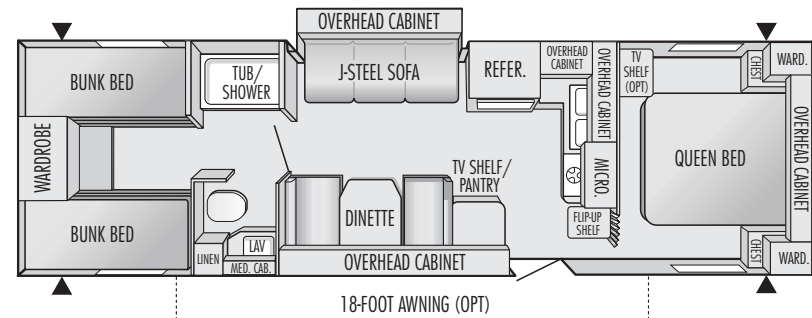

# 2003 Qwest® Fifth Wheel Floorplans

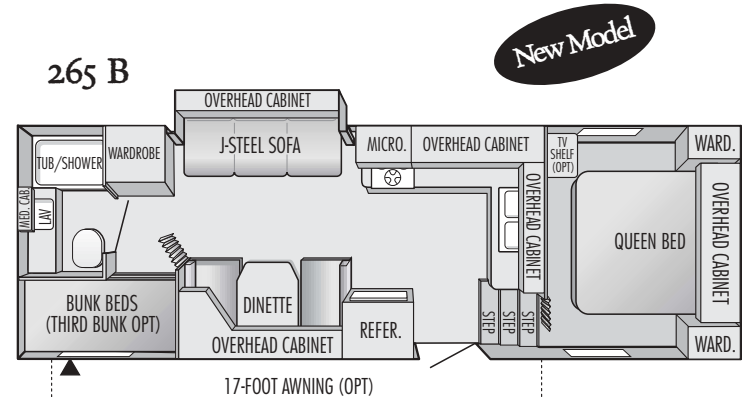
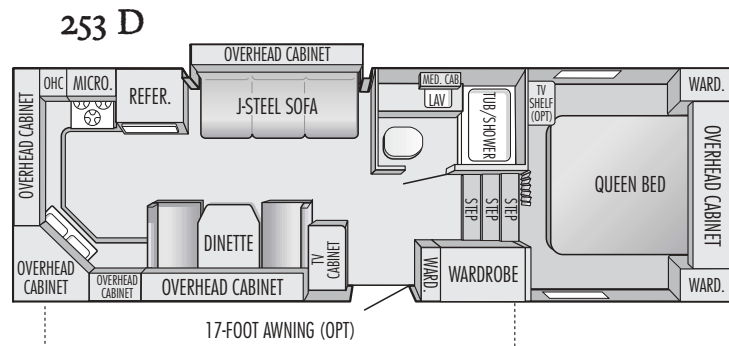

## 2003 QWEST® TRAVEL TRAILER AND FIFTH WHEEL SPECIFICATIONS

Models Fifthwheels	Exterior Length	Exterior Height	Bedroom Interior Height	Unloaded Vehicle Weight (lbs.)	Dry Hitch Weight (lbs.)	Gross Vehicle Weight Rating (lbs.)	Cargo Carrying Capacity (lbs.)	Fresh Water Capacity^ (gals.)	Gray Wastewater Capacity (gals.)	Toilet/Black Wastewater Capacity (gals.)
253 D	27'-6"	128"	52"	5535	1085	8500	2965	37*	34*	34*
265 B	28'-6"	128"	52"	5595*	1080*	8500	2405*	37*	34*	34*
<b>Travel Trailers</b>										
190 L	21'-11"	119"	77"	3795	445	5500	1705	37*	34*	34*
244 B	25'-11"	119"	77"	4325	515	6100	1775	37*	34*	34*
246 K	25'-11"	119"	77"	4270	670	6100	1830	37*	34*	34*
256 D	28'-8"	119"	77"	4995	540	6500	1505	37*	34*	34*
294 J	30'-6"	119"	77"	5120*	685*	7600*	2480*	37*	34*	34*
324 G	33'-9"	119"	77"	5380	600	7600	2220	37*	34*	34*

\* Estimated

^Includes Water Heater

**Unloaded Vehicle Weight (UVW):** Sometimes referred to as "Dry Weight," UVW means the typical weight of this trailer as built at the factory. The UVW, as used in product literature and other promotional materials, does not include cargo, fresh water, LP gas, options or dealer-installed accessories.

**Gross Vehicle Weight Rating (GVWR):** GVWR means the maximum permissible weight of the trailer, including the UVW plus passengers, personal items, all cargo, fluids, options and dealer-installed accessories. The GVWR is equal to or greater than the sum of the UVW and the CCC.

**Cargo Carrying Capacity (CCC):** CCC means the maximum weight of all passengers, personal items, food, fresh water, LP gas, tools, other cargo and dealer-installed accessories that can be carried by the trailer. CCC is equal to or less than GVWR minus UVW.

\*The addition of options will decrease the CCC.

It is important for your safety and enjoyment that your tow vehicle be adequately sized and equipped to tow and handle the GVWR of the RV you select. Review weights and rating of your tow vehicle and consult a competent advisor for questions

or advice. Whether you are new to RVing or a veteran, get a feel for the performance of your tow vehicle and the RV together before heading out on the roadways. **When you tow an RV, you must drive differently than you do when driving a single vehicle.** Practice hooking up, driving, backing up and braking in a safe environment or seek out professional instruction.

See specification chart above. Jayco affixes a weight label to each new RV which lists weight information for that vehicle.

# 2003 Qwest® Travel Trailer and Fifth Wheel Standards and Options

## STANDARD EXTERIOR FEATURES

15" radial tires (most models)  
Radius lockable storage compartments with grab handles  
PolyFlex™ underbelly covering  
Retractable double entrance step  
Colored radius skirting  
Patio light with inside switch  
26" white radius-framed fiberglass entrance door  
White radius-cornered awning windows  
Hitch safety chains (travel trailer)  
Bumper with drain hose carrier  
TPO rubber roof with 12-year warranty  
R-7 sidewall, roof and floor insulation  
Long pin box (fifth wheels)  
\* E-Z Lube® Axles  
\* Jake Plate™ (fifth Wheels)

## STANDARD BATHROOM FEATURES

ABS tub/shower  
Shower curtain  
Towel holder  
Marine toilet  
Large bath sink  
Medicine cabinet with mirror  
Carpet w/pad (fifth wheels only)  
\* Light switch

## STANDARD KITCHEN FEATURES

Residential-style mixing faucet  
Residential-style stainless steel sink  
Color-coordinated counter tops  
Extra-deep kitchen drawers  
Flush-mounted double door refrigerator  
Pots and pans drawer (some models)  
Deep, lipped overhead cabinets  
Range cover  
Three-burner range with 9,000-BTU SuperBurner™ and piezo igniter

\* New for 2003

Samsung® microwave  
Wallpaper border

## STANDARD HEAT, POWER AND WATER FEATURES

Twin 30-lb. gas tanks with regulator  
Water heater bypass kit  
Winterization kit  
City water hookup  
Systems monitor panel  
Demand water pump  
12V electrical system  
Deluxe 45-amp. 110V power converter  
6-gal. gas water heater  
30-amp. power cord  
110V exterior receptacle  
Auto-ignition furnace with thermostat  
In-floor ducted heating  
LP leak detector  
Fire extinguisher  
13,500-BTU air conditioner  
Rotocast holding tanks

## STANDARD LIVING ROOM FEATURES

Flat-panel oak doors and drawers  
J-Steel™ convertible sofa (some models)  
Vinyl flooring throughout  
Coordinated decorator fabrics throughout  
Valances, w/lambrequins  
Mini blinds  
TV antenna with signal booster  
Cable TV hookup  
Stereo AM/FM cassette, 2 speakers  
Manual operated slide-out system (select models)

## STANDARD BEDROOM FEATURES

Innerspring mattress  
Coordinated, quilted bedspread

Privacy curtain closure  
Lift-up bed platform w/gas struts  
Windows in upper bunk  
\* Bi-fold door (N/A 190L)

## OPTIONAL FEATURES

Triple bunk (some models)  
Front living room (some models)  
Bedroom TV shelf (most models)  
Kitchen sink cover (1)  
Removable bedroom carpet (travel trailers)  
Tinted safety glass  
Front window with stone guard (travel trailers)  
Stabilizer jacks  
Electric jacks (fifth wheels)  
Snap jacks (fifth wheels)  
ABS gas bottle cover (travel trailers)  
15,000-BTU central A/C (most models)  
Power roof vent in bath  
6-gal. gas/electric DSI water heater  
Awning  
Center tension rafter  
Outside shower  
AM/FM Stereo CD Player w/2 speakers  
Spare tire with hinged tire carrier  
Vinyl tire cover  
Skylight  
Insulated holding tank  
KidStuf™ bunk organizer (some models)  
Outside stove  
Outside portable gas barbecue grill with carrying case  
\* Water purifier  
\* Electric slideout room system  
\* Family 2-way radio system (some models)



As a Jayco owner, you can be part of the Jayco Jafari International Travel Club. Ask your dealer about the Jafari "flight" in your area, write Jayco direct or visit our Web site.

**Please Note:** All information in this brochure is the latest available at the time of publication approval. Jayco reserves the right to make changes and to discontinue models without notice or obligation.

Pictures in this brochure may show optional equipment. RVs built for sale in Canada may differ to conform to Canadian codes.

Printed on recycled paper.



©2002 Jayco, Inc. 0702-15M Litho in U.S.A.



Jayco, Inc. P.O. Box 460 Middlebury, IN 46540  
[www.jayco.com](http://www.jayco.com)