



MELBOURNE PRESTIGE

24LP

OPTIONS: A, B

24NP

OPTIONS: B

OPTIONS

A



Theater Sofa

B



B+ Front Cap with Overhead Storage

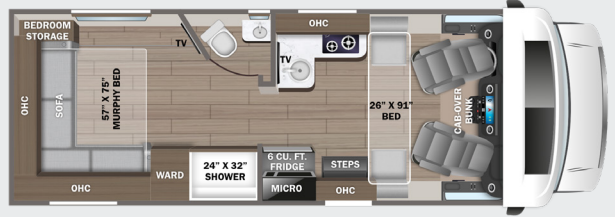
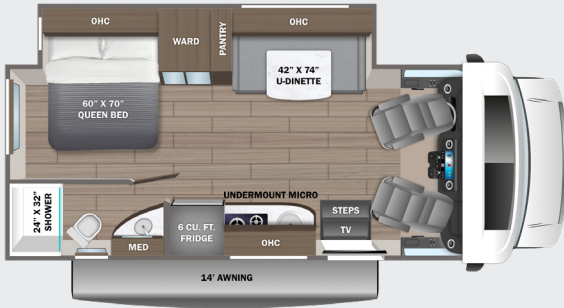

24RP

OPTIONS: A, B

24TP

OPTIONS: B

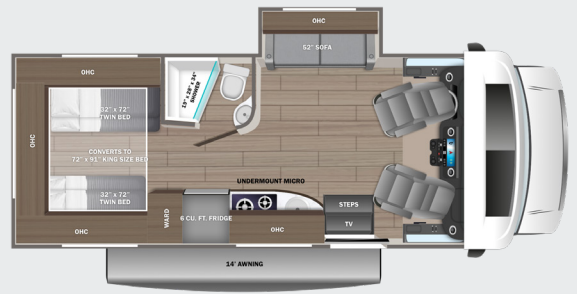
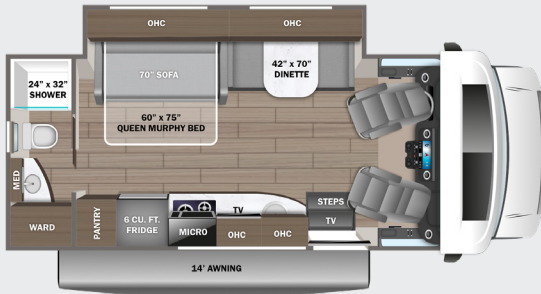

EXTERIOR SELECTIONS



Azurite Full-Body Paint



Early Frost Full-Body Paint



Driftscape Full-Body Paint

STANDARDS & OPTIONS

CUSTOMER VALUE PACKAGE

One-piece, seamless, fiberglass front cap
Automotive-bonded, panoramic window in front cap with power shade
Frameless windows
Backup and side-view cameras
Girard® armless patio awning with LED light strip
1,000W inverter
Heated holding tanks (12V pads)
Truma AquaGo Comfort Plus tankless water heater
Keyless cab entry
Power, swivel, heated leatherette driver and passenger seats

DRIVING

Premium Mercedes-Benz® 3500 chassis with 170 in. wheelbase
GVWR- 11,030 lb.
GCWR- 15,250 lb.
2L V4 Twin Turbo 211HP diesel engine with electronic fuel injection with 332 ft.-lb. torque
9-speed automatic transmission
220-amp alternator
E-rated highway tires- 215/85R16
Aluminum rims
Front and rear disc, 4-wheel anti-lock brakes
5,000 lb. rear hitch receiver with dual connector
7-pin plug
12V chassis battery
26.4 gal. fuel tank
5.8 gal. DEF tank
10.25 in. integrated Mercedes-Benz® MBUX infotainment center with GPS, Apple® CarPlay™ and Android Auto™
Heated, remote-controlled, side-view mirrors
Leather tilt steering wheel
Smartphone tray with wireless charging
Active Distance Assist DISTRONIC®
Active lane keeping assist
Crosswind assist
Hill start assist
Brake assist plus
Traffic sign assist
Attention assist
Breakdown management
Emergency call system
Rain-sensing windshield wipers

LED high performance headlights
Headlight assistant
Driver and passenger airbags
Power windows and door locks
Auxiliary start switch
Custom-molded ABS surround in cab-over area
Overhead bunk with 750 lb. capacity
Privacy curtain for cab area

EXTERIOR

StrongholdVBL™ roof, floor and sidewalls
Bead-foam insulation (R-24 max roof, R-9 max floor, R-5 max walls)
One-piece, seamless, fiberglass roof
Partial fiberglass rear cap
Premium Sikken full-body paint
Chrome grille
Electric stabilizer jacks
Slideout awning(s)
Entrance door with industry's largest travel-view window
Electric-powered entrance step with integrated house battery compartment
Aluminum skirt-hung baggage doors
Third brake light
Prep for satellite dish
Cable TV hookup with RG-6 coax
Winegard 2.0 Wi-fi/4G antenna
Onan® 3,600W LP generator with auto gen start
200W solar panel with dual controller
(2) 12V house batteries
Transfer switch with reverse polarity protection
30-amp electrical service
12.2 gal. propane tank (41 lb.)
LP quick-connect hookup
Exterior utility center
Winterization drain system
Black tank flush
Outside shower
12V demand water pump
Water filtration system

INTERIOR

Custom-molded ABS surround in cab-over area
Overhead bunk with 750 lb. capacity
Firefly total coach control system with wall-mounted touchscreen and mobile app

80 in. interior ceiling height with padded vinyl ceiling
High-intensity LED ceiling lights
High-gloss hardwood fascia
Tecnoform® high-gloss cabinetry
Ball-bearing drawer guides
Jayco-exclusive, easy-operation legless dinette table (24RP)
U-shaped dinette with stow away pedestal legs (24LP)
12V USB charging station in dinette area
2-point lap safety belts in all designated seating locations
Car seat tethers (select floorplans)
Day/night roller shades
15,000 BTU A/C
30,000 BTU auto-ignition ducted furnace
Powered roof vent in living area with wall switch
LED HD TV in living area
6 cu. ft. 3-way refrigerator
2-burner, drop-in cooktop with flush cover
Convection microwave
Tecnoform® high-gloss countertops
Stainless steel sink with wooden cover/cutting board
Decorative kitchen backsplash
Shower with decorative surround and skylight
Stainless steel bathroom sink
Porcelain toilet with foot flush
Powered roof vent in bathroom with wall switch
Queen-size bed with bedspread (24LP)
Queen-size power Murphy bed (24RP)
Queen-size manual Murphy bed (24NP)
(2) twin-size beds with filler cushion converts to king-size bed (24TP)
USB port(s) in bedroom
Under-bed storage (select models)
LED HD TV in bedroom (24NP)
Bedroom TV prep (24LP, 24TP)
Large wardrobes
Smoke alarm
Carbon monoxide detector
Fire extinguisher

OPTIONS

Hydraulic leveling jacks
3,200W diesel generator
B-plus front cap
Theater seating ILO dinette (24LP, 24RP)
Folding windshield sun shade

FLOORPLAN	GVWR (lbs.)	GCWR (lbs.)	WHEEL BASE	OVERALL LENGTH	EXTERIOR HEIGHT WITH SATELLITE AND A/C	EXTERIOR WIDTH	INTERIOR HEIGHT	FRESH WATER CAPACITY (gal.)	GRAY WASTE WATER CAPACITY (gal.)	BLACK WASTE WATER CAPACITY (gal.)
24LP	11,030	15,250	170.3"	25' 2"	10' 11"	96"	80"	43	31	31
24NP	11,030	15,250	170.3"	25' 2"	10' 11"	96"	80"	35	31	31
24RP	11,030	15,250	170.3"	25' 2"	10' 11"	96"	80"	43	31	31
24TP	11,030	15,250	170.3"	25' 2"	10' 11"	96"	80"	29	31	31

Meet your Jayco Dealer



Scan QR code for specification definitions

Some specs at the time of print may include estimates. For the most updated information, please visit Jayco.com

Jayco Inc. | P.O. Box 460 | Middlebury, IN 46540

See dealer for further information and prices. All information in this brochure and on www.jayco.com is the latest available at the time of publication approval. Jayco reserves the right to make changes and to discontinue models without notice or obligation. Photography may show optional equipment or props used for decoration purposes only. RVs built for sale in Canada may differ to conform to Canadian codes. JAYCO and the JAYCO BIRD IN FLIGHT are registered trademarks of Jayco, Inc. Printed in USA 7/23 ©2023 Jayco, Inc. 2032811.2024



Jayco - Part of Jayco Family of Companies