

Jayco | 2026 Eagle HT Fifth Wheel



EAGLE HT FIFTH WHEEL

ADVENTURES AROUND EVERY BEND



2+3
YEAR | YEAR
WARRANTY





EAGLE HT FIFTH WHEEL



25RUC OPTION: B

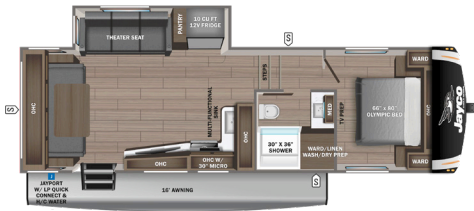

26REC OPTIONS: A, B, C

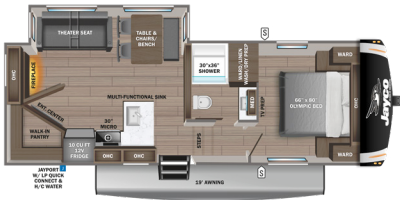

27MLC OPTIONS: B, C



28CRT OPTIONS: A, B



29ddb OPTIONS: B, C, E

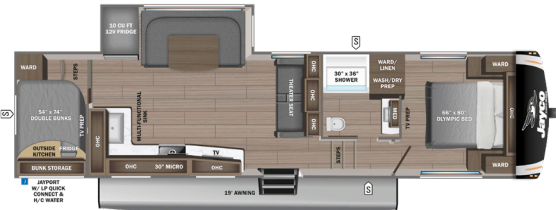

29RLC OPTIONS: A, B

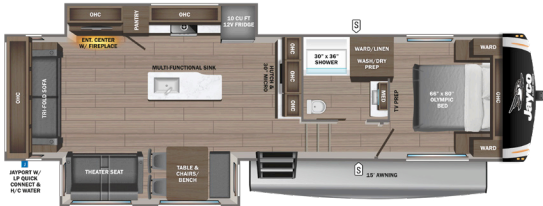

30CRT OPTIONS: A, B

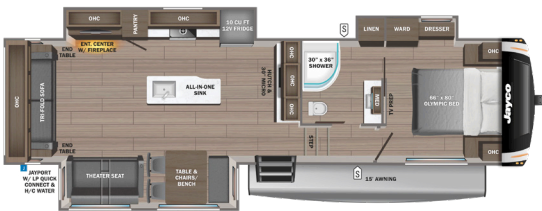

310CD OPTIONS: B, C, E

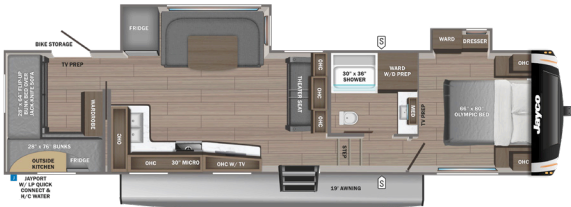

OPTIONS

A



Dinette

B



Griddle/Table

C



Tri-fold Sofa

D



Theater Seat

E



Triple Recliner



STORAGE

MICRO

MICROWAVE

OHC

OVERHEAD CABINETS

FRIDGE

REFRIGERATOR

WARD

WARDROBE

STANDARDS & OPTIONS

EXTERIOR

5 in. fresh water drain valve
 5 in. Magnum Truss™ with plywood roof decking
 AlphaPly TPO roof membrane (thickest roof membrane with limited lifetime warranty)
 50-amp detachable power cord
 LED lighting in pass-through area
 Auto-grade vinyl graphics
 Automotive-style front cap with max turn radius (painted on select models)
 Black tank flush
 Additional dump valve at termination
 LED light and switch at termination
Climate Shield™ zero-degree tested weather protection:
 Fully enclosed and heated underbelly (ducted)
 5K BTU furnace
 Double-layer fiberglass batt insulation in ceiling and floor
 Double-sided radiant barrier insulation (roof, floor, and behind cap)
 PEX plumbing
 Commercial-grade rubber flooring in pass-through area
 Dual 30 lb. LP bottles
 Factory-installed roof ladder
 Galvanized steel-coated outside kitchens
HELIX Cooling System™ (industry exclusive):
 Insulated dual duct design
 Directional and closeable A/C vents
 Larger return air vents with user-accessible filters
 Independent satellite and cable hookups (outside kitchens and/or pass-through storage areas)
 LED exterior lighting package
 LP quick-connect for gas griddle (next to JayPort®)
 Metal slam-latch baggage doors
 Nautilus 2.5 water connections
 Nitrogen-filled undermount spare tire (model/option varies: 15 in. or 16 in.)
 Quick-connect water connections (door-side hot/cold and off-door side cold only)
 Slide topper/awning prep
 Stronghold VBI™ walls (laminated sidewalls, rear walls, and slide-out walls)
 Rear camera prep
 30 x 22 in. shower skylight

INTERIOR

2-piece high-gloss bathroom surround
 Teak seat shower prep
 5/8 in. tongue-and-groove plywood flooring
 75 lb. full-extension drawer guides
 Bathroom skylight

Bedroom TV, SAT, and cable prep
 C.P.A.P.-prepped bedroom (both sides)
 Extra 120V power outlets in kitchen and slide rooms (where applicable)
 Gas-strutted under-bed storage
 High-sheen handcrafted door/drawer fronts
 Medicine cabinet with custom-framed mirror
 Kitchen faucet with pull-out sprayer
 Porcelain foot-flush toilet
 Residential vinyl flooring throughout (no carpet)
 Theater seating (select models)
 Tri-fold hide-a-bed sofa with residential memory foam sleep surface (select models)
 USB-C 12V charging ports (multiple locations throughout)
 Water shut off at all faucet locations
 NuvoH2O Water Treatment System (filters included)
 100% no floor heat vents
 4 in. interior ceiling fan lighting (4000K lumen)

CUSTOMER VALUE PACKAGE (MANDATORY)

15K BTU "Whisper Quiet" A/C and bedroom A/C prep
 4K Ultra LED HD Smart TV in living room
 50-amp service with dual A/C ducts
 60K on-demand tankless water heater
 Custom-machined aluminum rims
 Electric patio awning (integrated dimmable LED lights with JAYCOMMAND™)
 Hidden hinges on cabinet doors
 Interior & exterior "Blue Sync" Audio Connect with MB Quart sound (TV & phone)
 Keyed-Alike™ lock system
 MORryde Step Above™ entrance steps (main entrance)
 Rain-proof bathroom power vent
 Rear 2 in. towing receiver (4-pin connector on fifth wheels only)
 Winegard Air 360 + antenna & router prep (NOW 5G)
 Inverter pre-wire (multiple locations throughout)
Overlander I Solar Package (200W panel and 30-amp solar controller)

LUXURY PACKAGE (MANDATORY)

Blackout roller shades with reflective side throughout
 Electric auto-leveling
 GE 10 cu. ft. 12V refrigerator with black glass front
 JayPort® 2 in. mount (for outside accessories)

Residential-style glass shower door
 Washer/dryer prep (select models)
 GE 30 in. over-the-range black and stainless microwave with exhaust fan
 GE black and stainless 21 in. range with edge-to-edge grates
 Multi-function "All-in-One" black stainless steel kitchen sink
 Residential 66 x 80 in. OLYMPIC size mattress
 Magnetic catches for all drawers and doors
 Solid surface kitchen countertop(s)
 LED fireplace with 5K BTU electric space heater
 JAYCOMMAND™ with monitor switch panel
 Exterior light and outlet at the JayPort® location

4-STAR HANDLING PACKAGE (MANDATORY)

Dexter® axles with NEV-R-Adjust® brakes and E-Z Lube® hubs
 15 in. "E" rated tires or 16 in. "H" rated tires
 MORryde® CRE-3000™ rubberized suspension
 Wet bolt fasteners with bronze bushings

OPTIONS

15K BTU bedroom A/C
 HALO™ 22 in. outside griddle with deep sink attachment for JayPort® system
 Booth dinette (select models)
 Dry camping package (generator prep; extra LP capacity)
 Extreme Weather Package with 120 heat pads and 12V heat tape on freshwater line
 Free-standing table with leaf, two chairs, and bench seat
 Overlander II Solar Package: (2) 200W panels, 30-amp controller, and 1800W inverter
 Theater seating in place of tri-fold sofa (select models)
 Furniture cup holder tables (1 pair)
 Dexter® ABS brake system with anti-sway
 Triple reclining sofa in place of dinette (select models)
 SpartanLync™ Tire Pressure Monitoring System

*Indicates split tanks
 **2025 specs listed

| FLOORPLAN | TOTAL EXTERIOR LENGTH | EXTERIOR WIDTH | EXTERIOR HEIGHT (WITH A/C) | INTERIOR HEIGHT (MAIN) | INTERIOR HEIGHT (UPPER DECK) | UNLOADED VEHICLE WEIGHT | DRY HITCH WEIGHT | GVWR | CARGO CARRYING CAPACITY | FRESH WATER CAPACITY | GRAY WASTE WATER CAPACITY | BLACK WASTE WATER CAPACITY | SLEEPING CAPACITY |
|-----------|-----------------------|----------------|----------------------------|------------------------|------------------------------|-------------------------|------------------|--------|-------------------------|----------------------|---------------------------|----------------------------|-------------------|
| 25RUC | 29' 9" | 8' 0" | 12' 3" | 8' 5" | 6' 4" | 8,120 | 1,640 | 9,800 | 1,680 | 52 | 82* | 45 | 2-4 |
| 26REC | 29' 3" | 8' 1" | 12' 5" | 8' 5" | 6' 4" | 8,355 | 1,725 | 9,995 | 1,640 | 52 | 82* | 45 | 4-6 |
| 27MLC | 32' 9" | 8' 1" | 12' 6" | 8' 5" | 6' 4" | 8,625 | 1,765 | 10,400 | 2,860 | 52 | 82* | 45 | 2-4 |
| 28CRT | 32' 10" | 8' 1" | 12' 5" | 8' 5" | 6' 4" | 9,595 | 1,990 | 11,400 | 1,805 | 52 | 82* | 45 | 2-4 |
| 29DDB | 34' 7" | 8' 1" | 12' 11" | 8' 5" | 6' 4" | 9,240 | 1,685 | 10,995 | 1,755 | 52 | 82* | 45 | 8-10 |
| 29RLC | 34' 0" | 8' 1" | 12' 3" | 8' 5" | 6' 4" | 9,485 | 1,635 | 11,200 | 1,715 | 52 | 82* | 45 | 4-6 |
| 30CRT | 34' 0" | 8' 1" | 12' 3" | 8' 5" | 6' 4" | 9,725 | 1,915 | 11,600 | 1,875 | 52 | 82* | 45 | 2-4 |
| **31QCD | 36' 8" | 8' 1" | 12' 6" | 8' 5" | 6' 4" | 9,817 | 2,215 | 11,700 | 1,883 | 52 | 82* | 45 | 5-7 |

Meet your Jayco Dealer



Scan QR code for specification definitions



Some specs at the time of print may include estimates. For the most updated information, please visit [Jayco.com](https://www.jayco.com)

Jayco, Inc. | P.O. Box 460 | Middlebury, IN 46540

See dealer for further information and prices. All information in this brochure and on www.jayco.com is the latest available at the time of publication approval. Jayco reserves the right to make changes and to discontinue models without notice or obligation. Photography may show optional equipment or props used for decoration purposes only. RVs built for sale in Canada may differ to conform to Canadian codes. JAYCO and the JAYCO BIRD IN FLIGHT are registered trademarks of Jayco, Inc. Printed in USA 10/25 ©2025 Jayco, Inc. 2033107

Jayco - Part of Jayco Family of Companies