

Jayco | 2025 Seneca Prestige Super Class C Motorhome



SENECA PRESTIGE

POWER & LUXURY COMBINED

2+3
YEAR | YEAR
WARRANTY



WOOD SELECTIONS

STONEWALL MATTE GREY

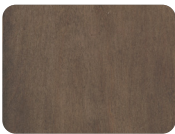

Wood

LINEN

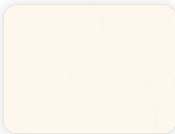

Wood

AUBURN MAPLE



Wood



Accent

ALMOND MAPLE



Wood



Flooring



Flooring

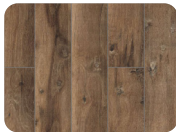

Flooring



Flooring

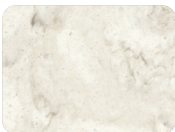

Countertop

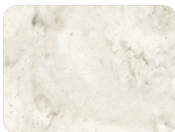

Countertop



Countertop

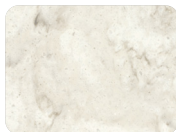

Countertop

FABRIC SELECTIONS

WALNUT

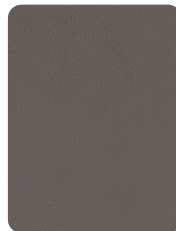

Furniture

BIRCH



Furniture

ASPEN



Furniture

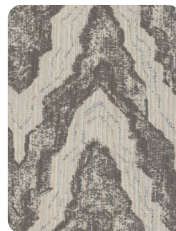

Main Fabric



Main Fabric



Main Fabric

OPTIONS

A



Hide-a-bed

B



Power Theater Sofa

C



Freestanding Dinette

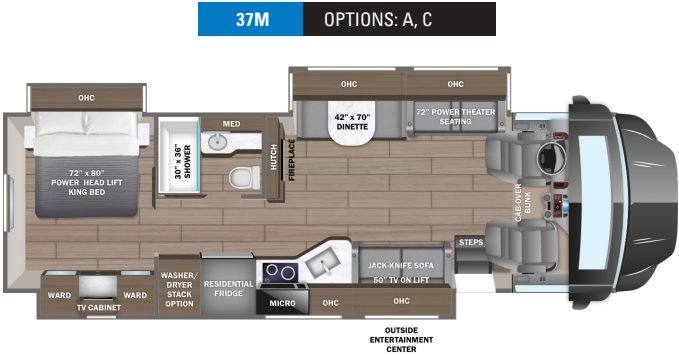
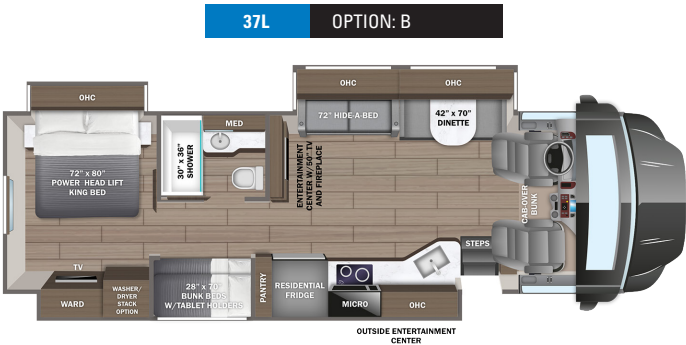
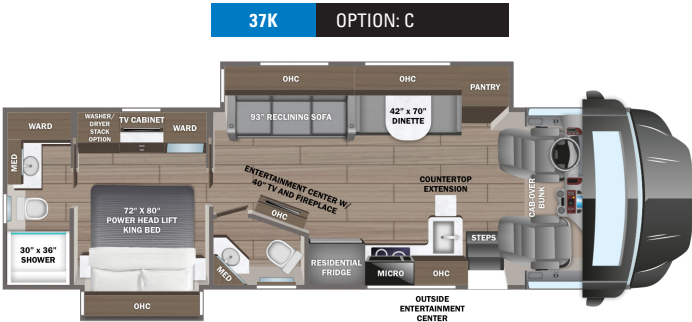

EXTERIOR SELECTIONS



Beacon Blue Full-Body Paint



Breezy Blue Full-Body Paint

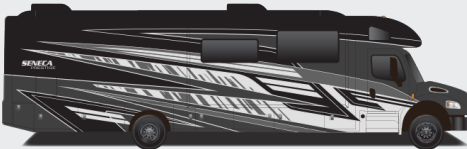

Dark Knight Full-Body Paint



Radiant Silver Full-Body Paint



Rosy Garnet Full-Body Paint

STANDARDS & OPTIONS

CUSTOMER VALUE PACKAGE

JRide® Premium: Computer-balanced driveshaft, rear air suspension, heavy-duty rear stabilizer bar, full air brakes, SACHS shocks
Dual-pane, tinted, safety-glass windows
Roof-mounted Girard® patio awning with LED lights
2,000W pure sine wave inverter
Power cord reel with 50 amp service
Aqua-Hot® 250D hydronic water and heating system with 5 in. LED screen
9 in. Sony® infotainment center with Apple CarPlay® and Android Auto™
Backup and side-view cameras
Stainless steel residential refrigerator
Flush-mounted convection microwave

DRIVING

Freightliner® S2RV Plus front engine diesel Super C cab chassis
Cummins® ISB 6.7L 360 HP diesel engine with 800 ft.-lb. torque
Allison® 3000 MH automatic transmission
Variable geometry engine exhaust brake
185 amp alternator
Michelin® tires- 275/80R 22.5 14 ply
12,000 lb. rear hitch receiver
7-pin plug
Dual 12V chassis batteries - 1900 CCA
100 gal. fuel tank
10 gal. DEF tank
6-way power driver and passenger seats
Auxiliary start switch
Privacy curtains for cab area
Color-coordinated carpeted floor mat

EXTERIOR

Onan® 8,000W diesel generator with auto-gen start
(4) 6V AGM (220Ah) house batteries on slideout tray
200W solar panel with dual controller
Dual 15,000 BTU A/C unit with heat pump on main A/C
5,000 BTU thermostat-controlled electric fireplace
Thetford® Sani-Con Turbo macerator system
Exterior utility center
Winterization drain system
Black tank flush
Outside shower
12V demand water pump
Water filtration system
Power windows and door locks
Tilt and telescoping leather-wrapped steering wheel
StrongholdVBL™ roof, floor and sidewalls for superior insulation and sound absorption
One-piece, seamless, crowned fiberglass roof
Bead-foam insulation (R-24 max roof, R-9 max floor, R-8 max walls)
One-piece, seamless, fiberglass front and rear caps
Automotive-bonded panoramic window in front cap with power shade
Premium Sikkens full-body paint
Automatic hydraulic leveling jacks
Alcoa® aluminum rims

Exterior entertainment center with outside speakers, LED TV mounted on swivel bracket and AM/FM radio
Winegard® In-motion satellite dish
Deluxe heated, remote-controlled, side-view mirrors
Entrance door with industry's largest travel-view window
Electric-powered entrance step
Slideout cover awnings
Chrome exterior baggage door handles and locks
Carpeted, full pass-through storage compartments with lockable slam latch doors

INTERIOR

Overhead bunk with 750 lb. capacity and safety net with 300 lb. capacity
Collapsible bunk ladder
Firefly Multiplex system offers control of important coach features via LED touchscreen or mobile app
High-intensity recessed LED ceiling lights
Raised-panel hardwood cabinetry and stiles throughout
Deluxe hidden cabinet hinges
Matte-finish woodgrain porcelain floor tile with heated floor mat
Day/night roller shades in living area
Jayco-exclusive, easy-operation legless dinette table
Car seat tethers on forward-facing dinette seats
2-point lap safety belts in all designated seating locations
50 in. LED TV in living area (40 in. on 37K)
Samsung® sound bar
Cable TV hookup with RG-6 coax and video selector switch
Wood-framed kitchen window with spice cabinets
2-burner induction cooktop with LED display
Solid-surface kitchen countertop with large integrated stainless steel sink with sink covers
Walk-around, king-sized bed with bedspread and nightstands
32 in. Smart LED TV in bedroom
Large wardrobes
Bunks with industry-exclusive 300 lb. capacity each (37L)
One-piece, fiberglass shower with glass door, skylight and light
Porcelain toilet with foot flush
Solid-surface bathroom sink
Powered roof vent in bathroom with wall switch
Smoke alarm
Carbon monoxide detector

OPTIONS

Power theater seating (37L only)
Hide-a-bed sofa (37M only)
Freestanding table with 4 chairs (N/A 37L)
Stackable washer/dryer
Starlink satellite internet system
Winegard® TRAV'LER® satellite dish - DIRECTV®
Winegard® TRAV'LER® satellite dish - Dish Network®
Canadian Shaw® TRAV'LER® satellite dish
Blackout package (includes all-black American Racing Octane wheels, bumper, grille and mirrors)

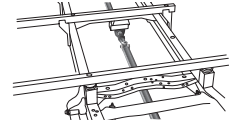

COMPUTER-BALANCED DRIVESHAFT

Ensures smooth and efficient power transfer to the wheels

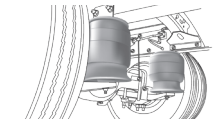

REAR AIR SUSPENSION

Softens ride and improves handling

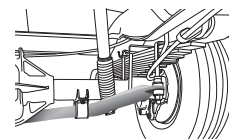

HEAVY-DUTY REAR STABILIZER BAR

A larger bar and polyurethane bushings, instead of rubber, transfer power faster for extra support, more stability and easier handling

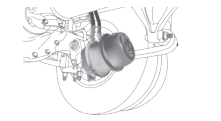

FULL AIR BRAKES

Deliver robust stopping power, even on grades

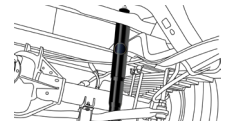

SACHS SHOCKS ABSORBERS

Large diameter tube design pairs gas and hydraulics to resist heat and pressure while independently adjusting to changing road conditions

FLOORPLAN	GVWR (lbs.)	GCWR (lbs.)	WHEEL BASE	OVERALL LENGTH	EXTERIOR HEIGHT WITH SATELLITE AND A/C	EXTERIOR WIDTH	INTERIOR HEIGHT	FRESH WATER CAPACITY (gal.)	GRAY WASTE WATER CAPACITY (gal.)	BLACK WASTE WATER CAPACITY (gal.)
37K	31,000	43,000	279"	39' 4"	13' 4"	101"	84"	72	51/40	40/23
37L	31,000	43,000	279"	39' 4"	13' 4"	101"	84"	72	50/31	50
37M	31,000	43,000	279"	39' 4"	13' 4"	101"	84"	72	40/40	33/23

Meet your Jayco Dealer



Scan QR code for specification definitions



Some specs at the time of print may include estimates. For the most updated information, please visit [Jayco.com](https://www.jayco.com)

Jayco Inc. | P.O. Box 460 | Middlebury, IN 46540

See dealer for further information and prices. All information in this brochure and on www.jayco.com is the latest available at the time of publication approval. Jayco reserves the right to make changes and to discontinue models without notice or obligation. Photography may show optional equipment or props used for decoration purposes only. RVs built for sale in Canada may differ to conform to Canadian codes. JAYCO and the JAYCO BIRD IN FLIGHT are registered trademarks of Jayco, Inc. Printed in USA 11/24 ©2024 Jayco, Inc. 2032962

Jayco - Part of Jayco Family of Companies