

Jayco | 2025 Melbourne Prestige Class C Motorhome



# MELBOURNE PRESTIGE

COMPACT COMFORT & LUXURY







CARLTON



Wood



Floor



Countertop



Main Fabric



Furniture



# MELBOURNE PRESTIGE



24LP OPTIONS: A, B

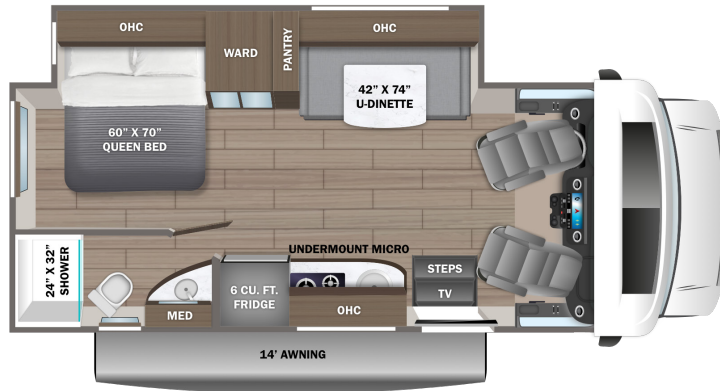

## OPTIONS

A



Theater Sofa

B



B+ Front Cap with Overhead Storage

24RP OPTIONS: A, B

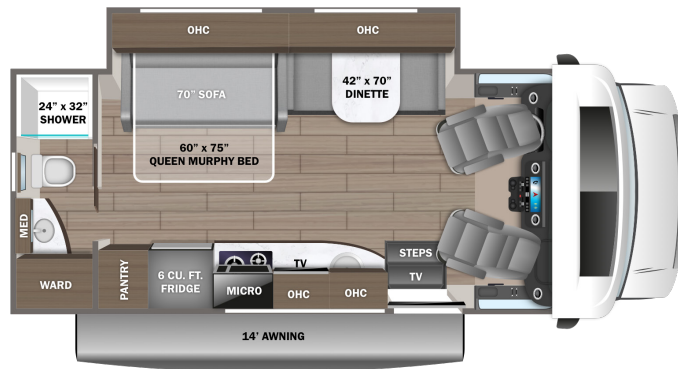

## EXTERIOR SELECTIONS



Admiral Frost Full-Body Paint



Luxardo Full-Body Paint



Seaside Full-Body Paint



Shale Full-Body Paint

# STANDARDS & OPTIONS

## CUSTOMER VALUE PACKAGE

One-piece, seamless, fiberglass front cap  
Automotive-bonded, panoramic window in front cap with power shade  
Frameless windows  
Backup and side-view cameras  
Girard® armless patio awning with LED light strip  
1,000W inverter  
Heated holding tanks (12V pads)  
Truma AquaGo Comfort Plus tankless water heater  
Keyless cab entry  
Power, swivel, heated leatherette driver and passenger seats

## DRIVING

Premium Mercedes-Benz® 3500 chassis with 170 in. wheelbase  
GVWR- 11,030 lb.  
GCWR- 15,250 lb.  
2.0L inline 4-cylinder Twin Turbo 211HP diesel engine with electronic fuel injection with 332 ft.-lb. torque  
9-speed automatic transmission  
220-amp alternator  
E-rated highway tires- 215/85R16  
Aluminum rims  
Front and rear disc, 4-wheel anti-lock brakes  
5,000 lb. rear hitch receiver with dual connector 7-pin plug  
12V chassis battery  
26.4 gal. fuel tank  
5.8 gal. DEF tank  
10.25 in. integrated Mercedes-Benz® MBUX infotainment center with Apple® CarPlay™ and Android Auto™  
Heated, remote-controlled, side-view mirrors  
Leather tilt steering wheel  
Smartphone tray with wireless charging  
Active Distance Assist DISTRONIC®  
Active lane keeping assist  
Crosswind assist  
Hill start assist  
Brake assist plus  
Traffic sign assist  
Attention assist  
Breakdown management  
Emergency call system  
Rain-sensing windshield wipers  
LED high performance headlights  
Headlight assistant  
Driver and passenger airbags

Power windows and door locks  
Auxiliary start switch  
Privacy curtain for cab area

## EXTERIOR

StrongholdVBL™ roof, floor and sidewalls  
Bead-foam insulation (R-24 max roof, R-9 max floor, R-5 max walls)  
One-piece, seamless, fiberglass roof  
Partial fiberglass rear cap  
Premium Sikkens full-body paint  
Chrome grille  
Electric stabilizer jacks  
Slideout awning(s)  
Entrance door with industry's largest travel-view window  
Electric-powered entrance step with integrated house battery compartment  
Aluminum skirt-hung baggage doors  
Third brake light  
Prep for satellite dish  
Cable TV hookup with RG-6 coax  
Winegard 2.0 Wi-fi/4G antenna  
3,600W LP generator with auto-gen start (4,000W on select models)  
200W solar panel with dual controller  
(2) 12V house batteries  
Transfer switch with reverse polarity protection  
30-amp electrical service  
12.2 gal. propane tank (41 lb.)  
LP quick-connect hookup  
Exterior utility center  
Winterization drain system  
Black tank flush  
Outside shower  
12V demand water pump  
Water filtration system

## INTERIOR

Custom-molded ABS surround in cab-over area  
Overhead bunk with 750 lb. capacity  
Firefly total coach control system with wall-mounted touchscreen and mobile app  
80 in. interior ceiling height with padded vinyl ceiling  
High-intensity LED ceiling lights  
Tecnoform® high-gloss cabinetry  
Ball-bearing drawer guides  
Jayco-exclusive, easy-operation legless dinette table (24RP)

U-shaped dinette with stow away pedestal legs (24LP)  
12V USB charging station in dinette area  
2-point lap safety belts in all designated seating locations  
Car seat tethers (select floorplans)  
Day/night roller shades  
15,000 BTU A/C  
30,000 BTU auto-ignition ducted furnace  
Powered roof vent in living area with wall switch  
LED HD TV in living area  
6 cu. ft. 3-way refrigerator  
2-burner, drop-in cooktop with flush cover  
Convection microwave  
Tecnoform® high-gloss countertops  
Stainless steel sink with wooden cover/cutting board  
Decorative kitchen backsplash  
Shower with decorative surround and skylight  
Stainless steel bathroom sink  
Porcelain toilet with foot flush  
Powered roof vent in bathroom with wall switch  
Queen-size bed with bedspread (24LP)  
Queen-size power Murphy bed (24RP)  
USB port(s) in bedroom  
Under-bed storage (select models)  
Bedroom TV prep (24LP)  
Large wardrobes  
Smoke alarm  
Carbon monoxide detector  
Fire extinguisher

## OPTIONS

Hydraulic leveling jacks  
B-plus front cap  
Theater seating ILO dinette  
Folding windshield sun shade

FLOORPLAN	GVWR (lbs.)	GCWR (lbs.)	WHEEL BASE	OVERALL LENGTH	EXTERIOR HEIGHT WITH SATELLITE AND A/C	EXTERIOR WIDTH	INTERIOR HEIGHT	FRESH WATER CAPACITY (gal.)	GRAY WASTE WATER CAPACITY (gal.)	BLACK WASTE WATER CAPACITY (gal.)
24LP	11,030	15,250	170.3"	25' 2"	10' 11"	96"	80"	43	31	31
24RP	11,030	15,250	170.3"	25' 2"	10' 11"	96"	80"	43	31	31

Meet your Jayco Dealer



Scan QR code for specification definitions

Some specs at the time of print may include estimates. For the most updated information, please visit [Jayco.com](http://Jayco.com)

Jayco Inc. | P.O. Box 460 | Middlebury, IN 46540

See dealer for further information and prices. All information in this brochure and on [www.jayco.com](http://www.jayco.com) is the latest available at the time of publication approval. Jayco reserves the right to make changes and to discontinue models without notice or obligation. Photography may show optional equipment or props used for decoration purposes only. RVs built for sale in Canada may differ to conform to Canadian codes. JAYCO and the JAYCO BIRD IN FLIGHT are registered trademarks of Jayco, Inc. Printed in USA 11/24 ©2024 Jayco, Inc. 2032957



Jayco - Part of Jayco Family of Companies