

EAGLE SLE FIFTH WHEEL



OPTIONS

A

Table & Chairs

B

60" Theater Seat Sofa

C

Table & Chairs/Bench

D

74" Theater Sofa

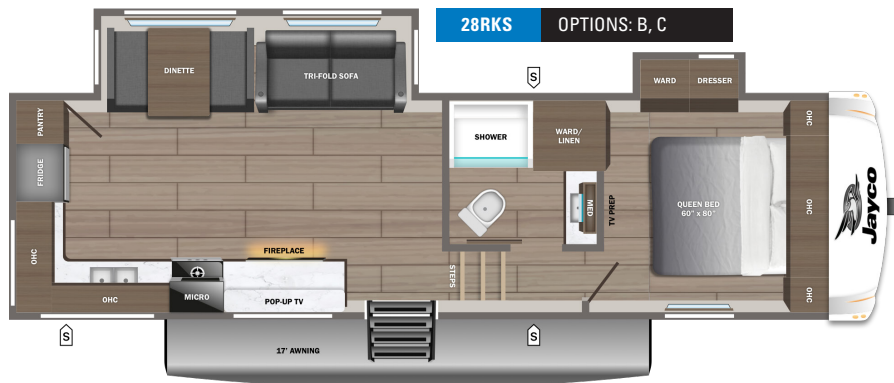
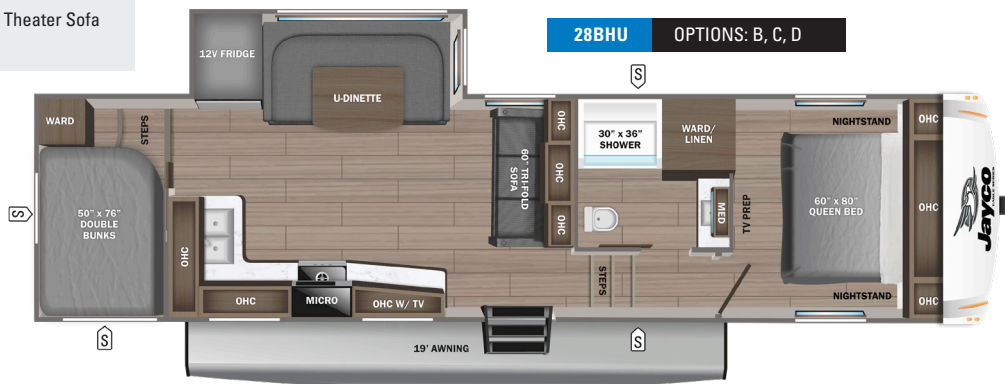
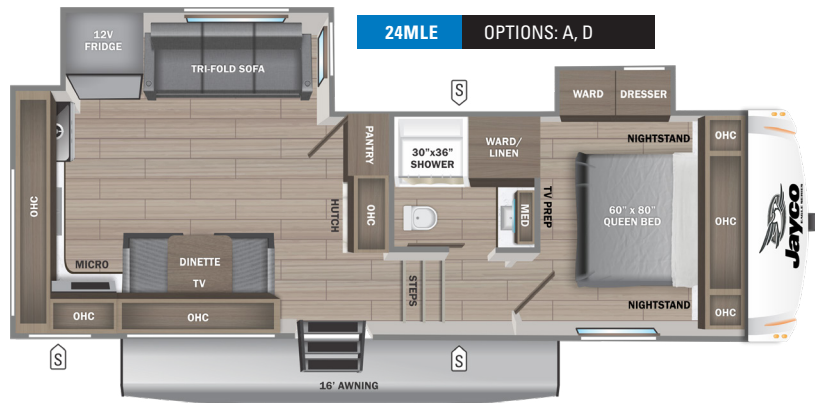

S STORAGE

MICRO MICROWAVE

OHC OVERHEAD CABINETS

FRIDGE REFRIGERATOR

WARD WARDROBE

STANDARDS & OPTIONS

EXTERIOR

1.5 in. fresh water drain valve
 5 in. Magnum Truss™ with plywood roof decking
 AlphaPly TPO roof membrane (thickest roof membrane with limited lifetime warranty)
 50-amp detachable power cord
 LED lighting in pass-through area
 Auto-grade vinyl graphics
 Automotive-style front cap with max turn radius
 Black tank flush
Climate Shield™ zero-degree tested weather protection:
 - Fully enclosed and heated underbelly (ducted)
 - 30K BTU furnace
 - Double-layer fiberglass batt insulation in ceiling and floor
 - PEX plumbing
 Commercial-grade rubber flooring in pass-through area
 Dual 30 lb. LP bottles
 Galvanized steel-coated outside kitchens
 Independent satellite and cable hookups (outside kitchens and/or pass-through storage areas)
HELIX Cooling System™ (industry exclusive):
 - Jayco® exclusive insulated dual-duct design
 - Directional and closeable A/C vents
 - Larger return air vents with user-accessible filters
 LED exterior lighting package
 LP quick connect for gas griddle (next to JayPort®)
 Quick-connect water connections (door side hot/cold)
 Metal slam-latch baggage doors
 Nitrogen-filled undermount spare tire
 Slide topper/awning prep
 Stronghold VBL™ walls (laminated sidewalls, rear walls, and slide-out walls)
 Rear camera prep
 15 in. "E" rated tires (including spare)

INTERIOR

2-piece high-gloss bathroom surround
 Teak seat shower prep
 5/8 in. tongue-and-groove plywood flooring
 75 lb. full-extension drawer guides
 Bathroom skylight
 Bedroom TV, SAT, and cable prep
 C.P.A.P.-prepped bedroom (both sides)
 Gas-strutted under-bed storage
 High-sheen handcrafted door and drawer fronts
 Medicine cabinet with custom-framed mirror
 Kitchen faucet with pull-out sprayer
 Porcelain foot-flush toilet
 Residential vinyl flooring throughout (no carpet)
 Tri-fold hide-a-bed sofa with residential memory foam sleep surface (select models)
 USB-C 12V charging ports (multiple locations throughout)
 Water shut off at all faucet locations
 100% no floor heat vents
 4 in. interior ceiling can light (4K lumen)
 30 x 22 in. shower skylight
 Dexter® suspension
 Wet bolt fasteners with bronze bushings

CUSTOMER VALUE PACKAGE (MANDATORY)

15K BTU "Whisper Quiet" A/C and bedroom A/C prep
 40 in. 4K Ultra LED HD Smart TV in living room
 50-amp service with dual A/C ducts
 60K on-demand tankless water heater
 Custom-machined aluminum rims
 Electric patio awning
 Hidden hinges on cabinet doors
 Interior "Blue Sync" Audio Connect with MB Quart sound (TV & phone)
 Keyed-Alike™ lock system
 MORryde® Step Above™ entrance step
 Rain-proof bathroom power vent

Rear 2 in. towing receiver (4-pin connector on fifth wheels only)
 Winegard® Air 360 antenna
 8 cu. ft. 12V refrigerator
 Inverter pre-wire throughout interior and exterior
 Electric rear stabilizer jacks
 Magnetic catches for all drawers and doors
 Overlander 1 Solar Package (200W panel and 30-amp solar controller)

OPTIONS

15K bedroom A/C
 Booth dinette (select models)
 Free-standing table with leaf, two chairs, and bench seat
 LED fireplace with 5K BTU electric space heater (select models)
 Overlander II Solar Package: (2) 200W panels, 30-amp controller, and 1800W inverter
 Theater seating in place of tri-fold sofa (select models)
 SpartanLync™ Tire Pressure Monitoring System

*Indicates split tanks

FLOORPLAN	TOTAL EXTERIOR LENGTH	EXTERIOR WIDTH	EXTERIOR HEIGHT (WITH A/C)	INTERIOR HEIGHT (MAIN)	INTERIOR HEIGHT (UPPER DECK)	UNLOADED VEHICLE WEIGHT	DRY HITCH WEIGHT	GVWR	CARGO CARRYING CAPACITY	FRESH WATER CAPACITY	GRAY WASTE WATER CAPACITY	BLACK WASTE WATER CAPACITY	SLEEPING CAPACITY
24MLE	29' 3"	8' 2"	12' 3"	8' 5"	6' 4"	7,855	1,485	9,500	1,645	52	82*	45	2-4
28BHU	34' 7"	8' 2"	13' 0"	8' 6"	6' 4"	8,485	1,605	9,995	1,510	51	82*	45	5-6
28RKS	TBD	TBD	TBD	TBD	TBD	TBD	TBD	TBD	TBD	TBD	TBD	TBD	2-4
30RLT	33' 12"	8' 1"	12' 2"	8' 5"	6' 3"	9,205	1,650	10,900	1,695	52	82*	45	2-4

Meet your Jayco Dealer



Scan QR code for specification definitions

Some specs at the time of print may include estimates. For the most updated information, please visit [Jayco.com](https://www.jayco.com)

Jayco, Inc. | P.O. Box 460 | Middlebury, IN 46540

See dealer for further information and prices. All information in this brochure and on www.jayco.com is the latest available at the time of publication approval. Jayco reserves the right to make changes and to discontinue models without notice or obligation. Photography may show optional equipment or props used for decoration purposes only. RVs built for sale in Canada may differ to conform to Canadian codes. JAYCO and the JAYCO BIRD IN FLIGHT are registered trademarks of Jayco, Inc. Printed in USA 010/25 ©2025 Jayco, Inc. 2033112

Jayco - Part of Jayco Family of Companies

